

# Tab C

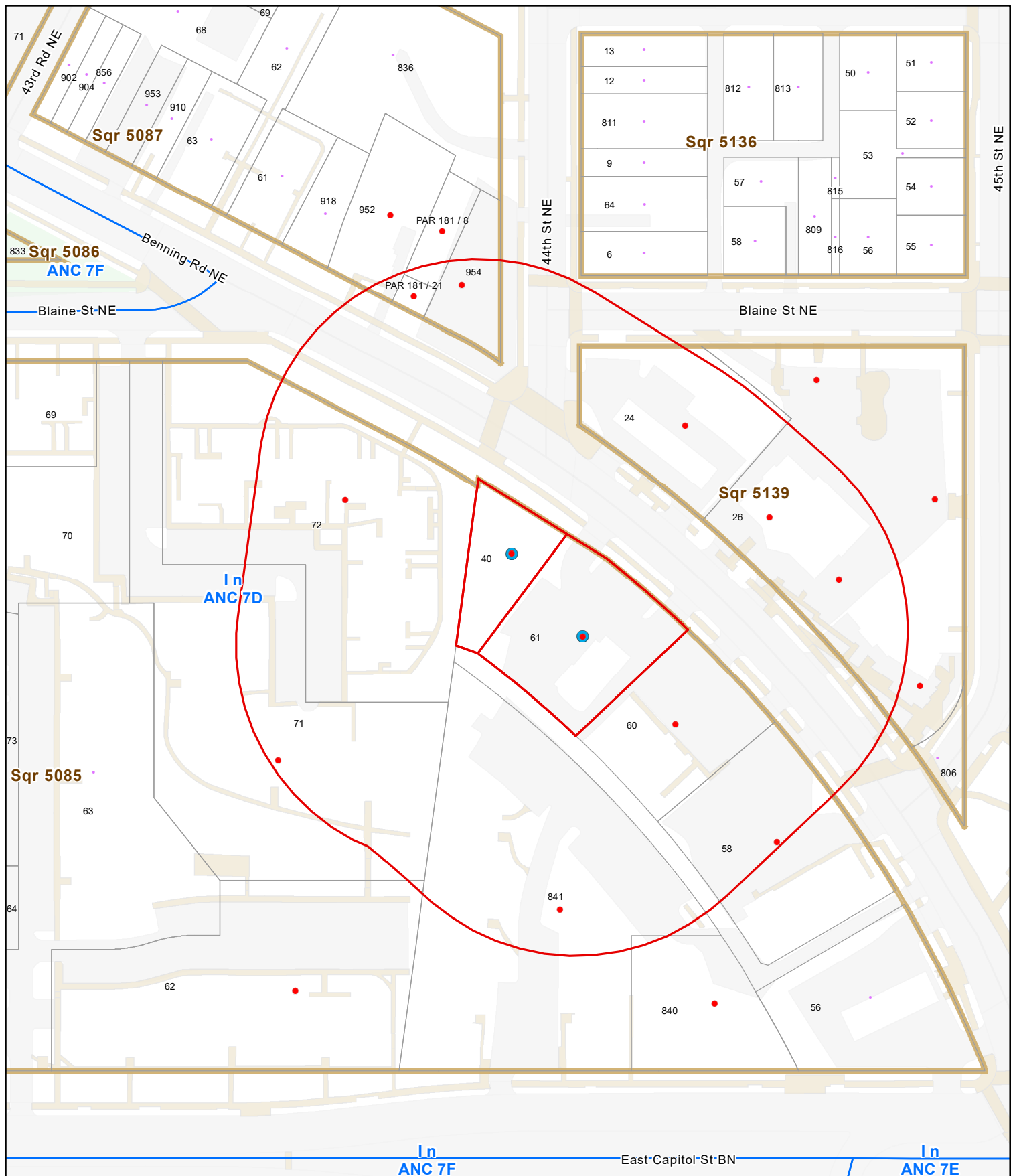



**Subject Property ID's:  
Square 5085 Lots 0061, 0040**

- Subject Properties
- Radius
- Ownership Lots
- DC Squares
- ANC Boundary

DC Office of Tax and Revenue  
Real Property Assessment Division  
Maps and Titles Assessment Roll  
Geographic Information Systems

1:1,403  
0 50  
Feet

Print Date: 6/21/2021

For general planning purposes

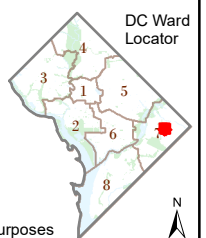



MEDLEY, ARTHUR L  
4380 BENNING RD NE  
WASHINGTON DC 20019-4553

NEW MOUNT CALVARY BAPTIST CHURCH  
4270 BENNING RD NE  
WASHINGTON DC 20019-4549

MEDLEY, ARTHUR L  
4380 BENNING RD NE  
WASHINGTON DC 20019-4553

STANDRARD FCP VENTURE LP  
1901 AVENUE OF THE STARS STE 395  
LOS ANGELES CA 90067-6058

SOME INC  
71 O ST NW  
WASHINGTON DC 20001-1258

STANDRARD FCP VENTURE LP  
1901 AVENUE OF THE STARS STE 395  
LOS ANGELES CA 90067-6058

ZS 4401 LLC  
151 HAVEN AVE  
PRT WASHINGTN NY 11050-3926

STANDRARD FCP VENTURE LP  
1901 AVENUE OF THE STARS STE 395  
LOS ANGELES CA 90067-6058

EHILEN, RAPHAEL  
6127 HANLON ST  
CAPITOL HGTS MD 20743-3260

BENNING RESIDENTIAL LLC  
60 O ST NW  
WASHINGTON DC 20001-1259

4443 BENNING ROAD LLC  
400 7TH ST SE  
WASHINGTON DC 20003-2707

BENNING RESIDENTIAL LLC  
60 O ST NW  
WASHINGTON DC 20001-1259

ZS BENNING LLC  
151 HAVEN AVE  
PRT WASHINGTN NY 11050-3926

BENNING RESIDENTIAL LLC  
4414 BENNING RD NE  
WASHINGTON DC 20019-4555

EXXON CORPORATION  
6820B COMMERCIAL DR  
SPRINGFIELD VA 22151-4220

BENNING PROGRAM LLC  
4430 BENNING RD NE  
WASHINGTON DC 20019-4555

EAST CAPITOL GARDENS  
PO BOX 21100  
WASHINGTON DC 20009-0600

AFFORDABLE HOUSING OPPORTUNITIES  
4420 BENNING RD NE  
WASHINGTON DC 20019-4555

EAST CAPITOL LLC  
6901 4TH ST NW  
WASHINGTON DC 20012-1967

